



Boundary Road | NW8



Must see one bedroom in ST JOHNS WOOD - Newly decorated one bedroom property in this highly desirable location being only moments from the numerous bus, transport, shops and cafes of Boundary Village. The apartment boasts bright reception with open plan kitchen, modern bathroom and double bedroom to rear aspect.

Tube station within walking distances St Johns Wood, Swiss Cottage (both Jubilee Line) & Maida Vale (both Bakerloo line). The Jubilee Line provides a direct route into Canary Wharf, one of the United Kingdom's main financial centres.

The building has been tastefully refurbished to offer modern communal parts. We highly recommend this wonderful property, please call us on 0207 625 1000

Camden Rates - Band C - £1,260
Admin and reference fee - £ 300 plus VAT
Inventory check in Fee - £125 Plus VAT
EPC Rating - B

£330 Per Week

Lettings: 020 7625 1000
Sales: 020 7625 7000



www.greenstone.com



www.facebook.com/greenstoneproperty



www.twitter.com/lewisgreenstone



www.youtube.com/user/greenstone



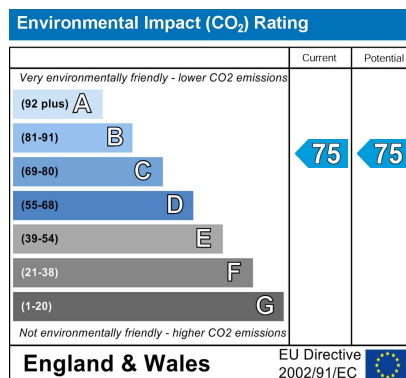
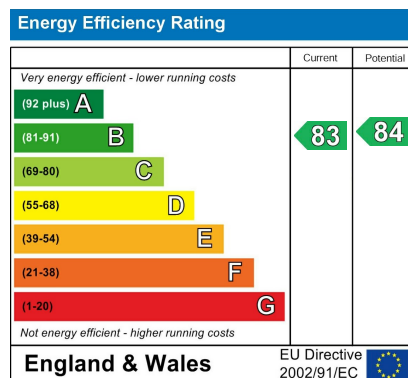

Lettings: 020 7625 1000
Sales: 020 7625 7000



www.greenstone.com



www.facebook.com/greenstoneproperty



www.twitter.com/lewisgreenstone



www.youtube.com/user/greenstone



Second Floor

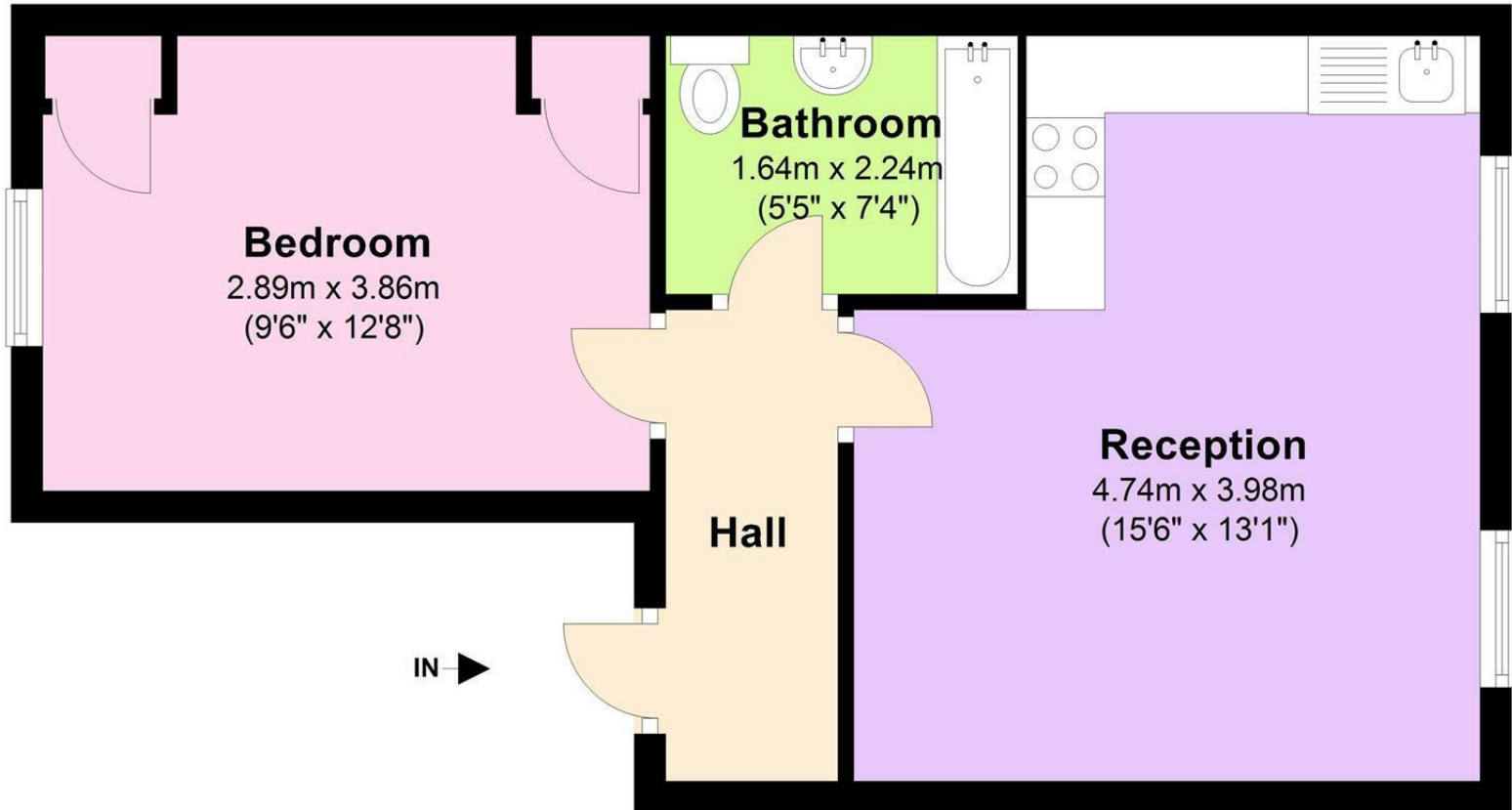

IMPORTANT NOTICE All of the information is intended only as a guide to a prospective purchaser and does not constitute any part of an offer or contract. Any measurements or distances referred to herein are approximate only. Any information contained herein (whether in the text, plans or photographs) is given in good faith and cannot be relied upon as being a statement or representation of fact. Should you proceed with the purchase of the property, your solicitor must verify these details. We have not carried out a detailed survey nor tested the services, appliances and specific fittings. In accordance with current legislation we would advise you that the measurements on these particulars are imperial. The formula for conversion to metric is as follows:- 1' (one foot) = 30.4cm (centimetres), 1m (one metre) = 3'29 (feet).