



Mortimer Crescent, NW6 £1,400 Per Month Furnished

Newly decorated, a great 2 bedroom apartment in the ever-popular Hillsborough Court, a Tudor Style Block with a central communal garden courtyard.

Set on the raised ground floor the property comprises one double bedroom and one single bedroom, spacious reception, a separate kitchenette, and a bathroom with a shower.

Mortimer Crescent is well located for the amenities of Boundary Village, Abbey Road and Kilburn High Road. Maida Vale Underground (Bakerloo Line) and Kilburn Park (Jubilee Line) are within easy access and numerous bus links into Londons West End are within a short walk.



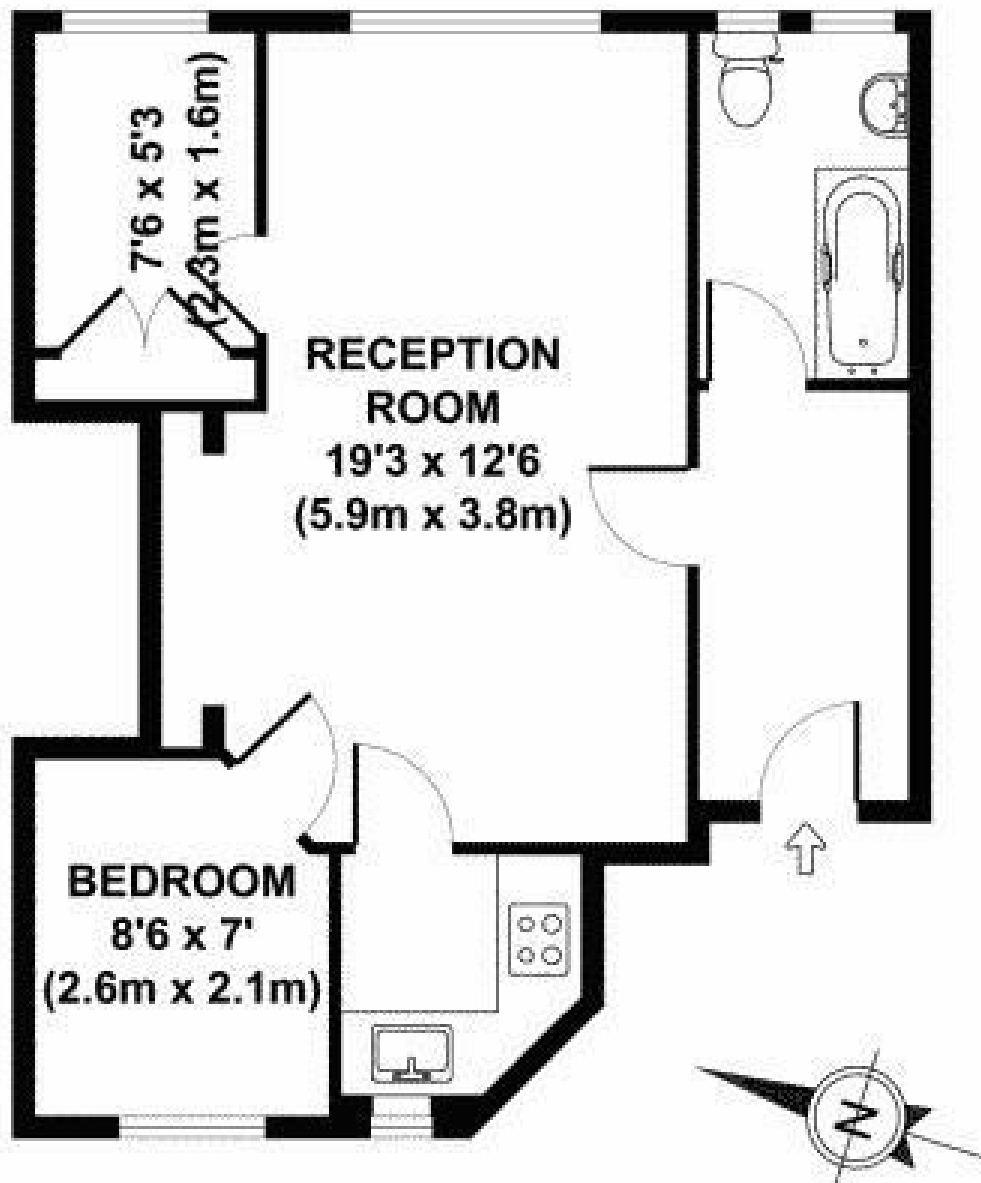

**GROUND FLOOR
GROSS INTERNAL
FLOOR AREA 447 SQ FT**

APPROX. GROSS INTERNAL FLOOR AREA 447 SQ FT / 41 SQ M

Ref: JW-CHPK0217142

ILLUSTRATION FOR IDENTIFICATION PURPOSES ONLY - NOT TO SCALE

Property Overview

Location	, NW6
Price	£1,400 Per Month
Bedrooms	2
Bathrooms	1
Receptions	1
Council	
Tax Band	C
Furnishing	Furnished

Key Features

- 2 Bedrooms
- Raised Ground Floor
- Communal Garden
- Great location
- Separate Kitchen
- Bathroom with Shower

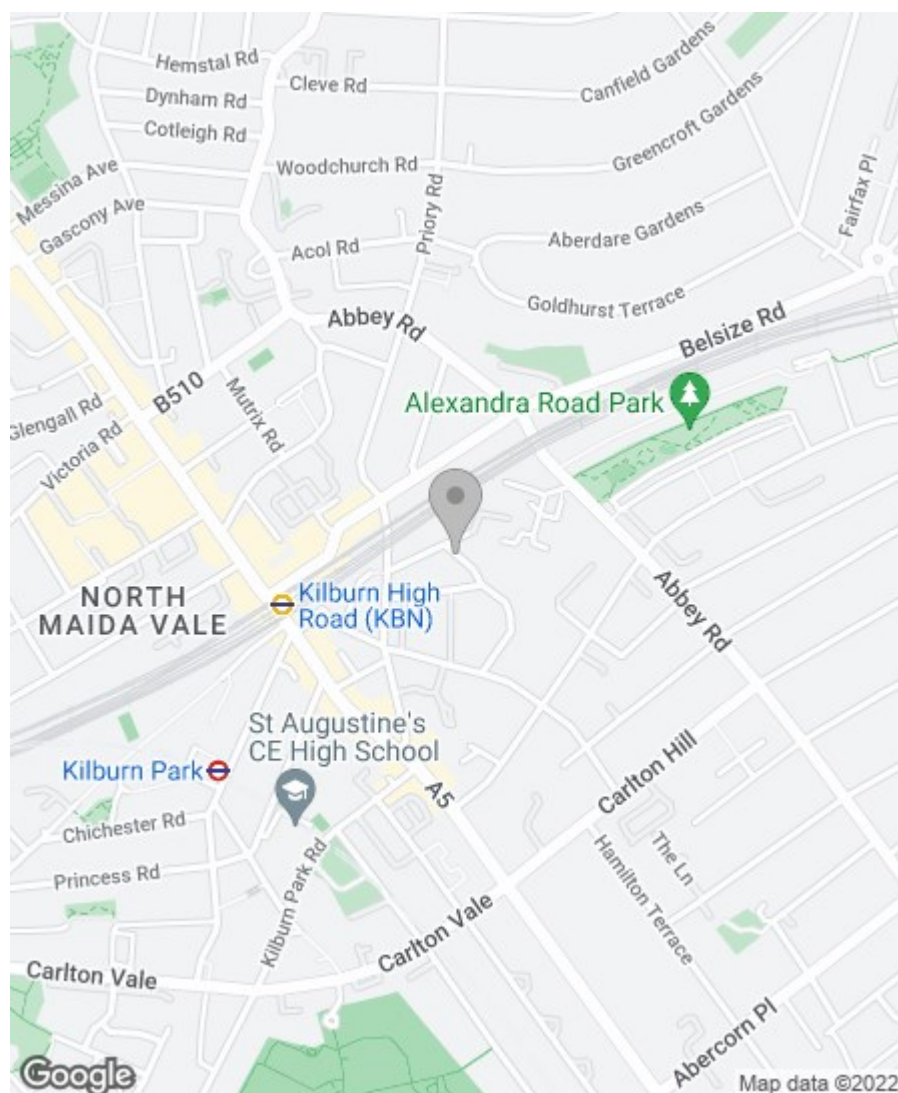

Energy Efficiency Rating

	Current	Potential
Very energy efficient - lower running costs		
(92 plus) A		
(81-91) B		
(69-80) C	68	68
(55-68) D		
(39-54) E		
(21-38) F		
(1-20) G		
Not energy efficient - higher running costs		

England & Wales

EU Directive
2002/91/EC



Environmental Impact (CO₂) Rating

	Current	Potential
Very environmentally friendly - lower CO ₂ emissions		
(92 plus) A		
(81-91) B		
(69-80) C	69	70
(55-68) D		
(39-54) E		
(21-38) F		
(1-20) G		
Not environmentally friendly - higher CO ₂ emissions		

England & Wales

EU Directive
2002/91/EC



IMPORTANT NOTICE: All of the information is intended only as a guide to a prospective purchaser and does not constitute any part of an offer or contract. Any measurements or distances referred to herein are approximate only. Any information contained herein (whether in the text, plans or photographs) is given in good faith and cannot be relied upon as being a statement or representation of fact. Should you proceed with the purchase of the property, your solicitor must verify these details. We have not carried out a detailed survey nor tested the services, appliances and specific fittings. In accordance with current legislation we would advise you that the measurements on these particulars are imperial. The formula for conversion to metric is as follows:- 1' (one foot) = 30.4cm (centimetres), 1m (one metre) = 3'29 (feet).